

Highlights

2 to 8 poles

Vertical pin strip

Spacing 5.0 mm

Pin length 2.0 mm

Total pin length 12.0 mm

Various pin lengths available

Reflow soldering

Automatic assembly (tape-on-reel)

THR

Wire Sizes

Solid min -

Solid max -

Stranded (flexible) min -

Stranded (flexible) max -

Stranded with ferrule min -

Stranded with ferrule max -

Dimensions

PCB hole diameter 1.3 mm

Materials

Contact pin Brass

Insulating Material

Material LCP

Flammability class UL 94 V-0

Temperatures

Operating temperature (without mech. load) -40 °C - 105 °C

Store temperature -40 °C - 105 °C

Wave Soldering Process

Soldering temperature, recommended 260 °C

Peak soldering time, recommended 3-4 s

**Technical Data // STL136/...-5.0-V-P2.0-BK-HT**

Spacing 5.0 mm

Reflow Process

Soldering temperature, recommended 217 - 245 °C

Peak soldering time, recommended 60 s

Colours

BLACK, RAL 9011

Colours according to RAL, there may be variations on colour due to production conditions.

Ratings

UseGroup				
	B	C	D	
Rated voltage	300 V	-	300 V	250 V
Rated current	10 A	-	10 A	7 A
Overvoltage category				III
Test voltage	1.60 kV	-	1.60 kV	4.0 kV
Pollution degree				2

* Approval

Counterparts (Spacing 5.0 mm)

Terminal Block

AK136

In combination of connectors with different admission data, the lower value is valid.

Tape on Reel

Number of Poles	Reel (RD/")	Width (R/mm)	Pitch (RP/mm)	Pieces (PCS)
2	13	24	12	275
3	13	24	12	275
4	13	56	16	200
5	13	56	16	200
6	13	56	16	200
7	13	56	16	200
8	13	56	16	200



Technical Data // **STL136/...-5.0-V-P2.0-BK-HT**

Spacing 5.0 mm

Order Data (Spacing 5.0 mm)

Number of Poles	Width (mm)	Article Designation	Article Number	PU
2	10.00	STL136/2-5.0-V-P2.0-BK-HT	50136025031R	275
3	15.00	STL136/3-5.0-V-P2.0-BK-HT	50136035031R	275
4	20.00	STL136/4-5.0-V-P2.0-BK-HT	50136045031R	200
5	25.00	STL136/5-5.0-V-P2.0-BK-HT	50136055031R	200
6	30.00	STL136/6-5.0-V-P2.0-BK-HT	50136065031R	200
7	35.00	STL136/7-5.0-V-P2.0-BK-HT	50136075031R	200
8	40.00	STL136/8-5.0-V-P2.0-BK-HT	50136085031R	200

Technical drawing

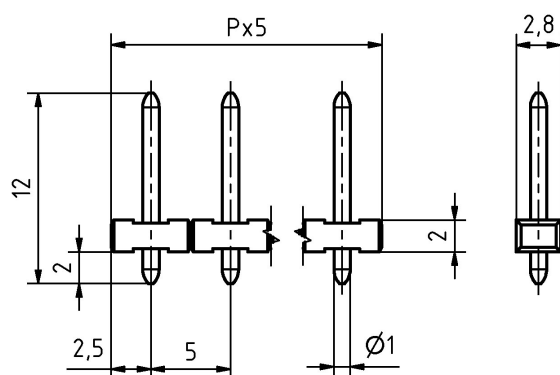



Technical Data // **STL136/..-5.0-V-P2.0-BK-HT**

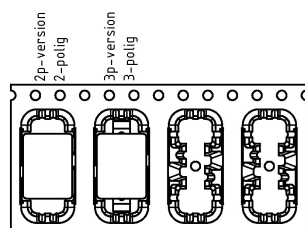
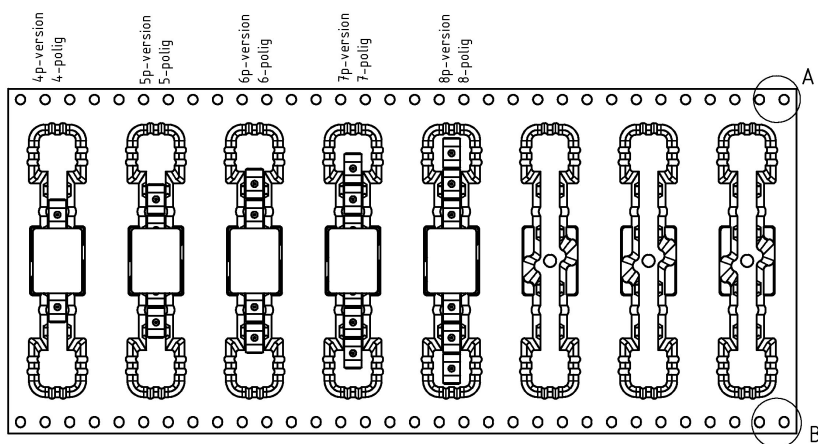

unreel direction
Abrollrichtung



A



B

